



Flexential Colorado tour guide





FlexAnywhere® Platform



Solve complex infrastructure requirements with colocation and cloud solutions tailored to meet your evolving needs.

The intricacy and cost associated with integrating, managing and protecting legacy applications, on-premise and cloud-based environments can be overwhelming. The Flexential consultative approach addresses your specific demands by tailoring our comprehensive colocation, cloud, data protection, managed and professional services portfolio to deliver optimal, long-term performance for your critical applications.

Highly connected, national platform

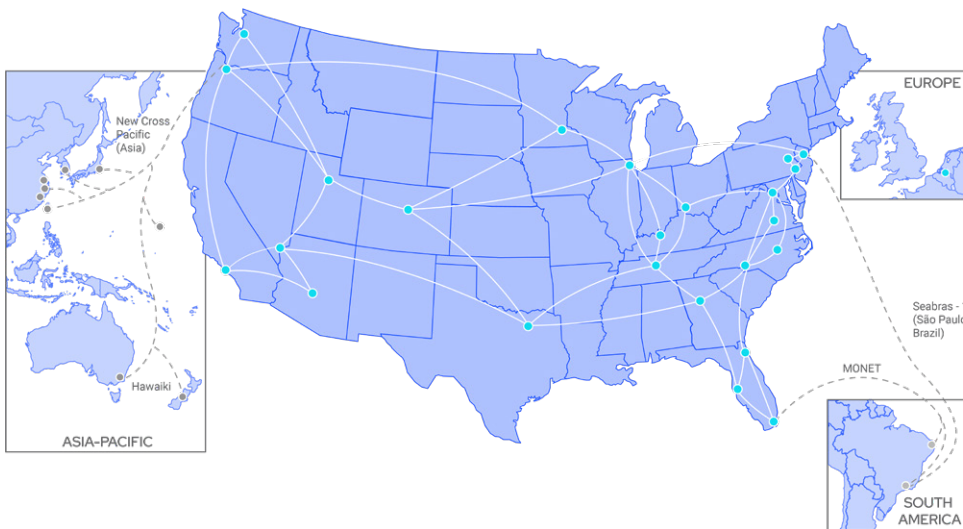

- Colocation | Cloud data centers | DRaaS data centers | Network PoPs | Cloud on ramps | Cloud Fabric
- Network backbone - - - Subsea cables

For an interactive map of our data centers, cloud regions, DRaaS regions, PoPs and cloud on ramps go to flexential.com

Broad reach and capabilities

100 Gbps
Network backbone

3 Million+
Sq. ft. footprint

310 MW
Critical load
UPS Capacity

300+
On-net carriers

19
US markets

40+
Data centers

Why Flexential?

With 40+ data centers across 19 markets, the Flexential highly connected, national data center platform and full suite of colocation, interconnection, cloud, data protection, and professional services, flex to empower our customers' evolving infrastructure requirements.

End-to-end data center solutions portfolio



Colocation

Benefit from secure, highly efficient data centers offering high-density power capabilities and geographic proximity for the utmost control of distributed architectures.



Interconnection

Access hundreds of carriers, hyperscale cloud providers and hybrid IT networks as well as 100 Gbps network backbone to enable your interconnection needs.



Cloud

Solve complex hybrid IT challenges and support long-term business growth by implementing private, public and hybrid cloud solutions.



Data protection

Protect your data, applications and infrastructure from disruptions using disaster recovery solutions as unique as your business requirements.



Professional Services

Accelerate your IT journey through consultative, end-to-end engagements that address the most complex infrastructure, security, and compliance challenges.

You're in good company

FRONTIER

 Centura Health®

AutoNation
Watch Customer Story

HITACHI
Inspire the Next

tyco

 **noodles**
& COMPANY

 **McAfee**

COX

QUESTBLUE

Flexential Interconnection

Create a powerful ecosystem
of clouds, partners, and customers
with interconnection services

Today's IT leader is juggling more complexity than ever before. Concerns over security, latency, performance, and cost combined with the reality of supporting an explosion of cloud-based applications, next generation technologies, disconnected systems of compute, storage, and databases that do not communicate with one another or provide scalability are common and painful business challenges.

In order to ensure optimal performance and long-term viability, savvy enterprises are shifting to a hybrid IT approach that matches workload and application requirements with the appropriate infrastructure solution. Further success is achieved by moving workloads closer to users to reduce latency and provide a consistent customer experience.

To optimize this hybrid approach, you need a partner with the physical infrastructure and connectivity options to seamlessly support today's requirements, the flexibility to accommodate future growth and the expertise to integrate, manage and protect your legacy applications, on-premise, colocated, and cloud-based environments.

Flexential Interconnection delivers scalable, industry-leading interconnection options through the combination of an industry-leading 100Gbps network backbone, hundreds of carriers, subsea cables, and low-latency connections to cloud providers to create an ecosystem that delivers secure and reliable connectivity options.

Optimize your corporate network

Leverage Flexential Interconnection to connect with cloud and software-as-a-service (SaaS) providers, customers, and partners, while increasing performance and reducing latency. Providing a distributed network approach allows businesses to access the breadth of the Flexential portfolio of services including data protection and managed services.

Flexential Fabric—An advanced, software-defined interconnection solution that enables direct, secure connectivity to distributed infrastructure and digital ecosystems through a single port.

DCI and Interconnection Mesh—Flexential flexible transport solutions, including Data Center Interconnect (DCI) and Interconnection Mesh enable connectivity between data centers on a 100Gbps backbone, connecting you to CSPs, peering exchanges, carriers and partners.

Cloud Fabric—Flexential Cloud Fabric provides a secure, Layer 2 private network transport to AWS, Azure, Google, and Oracle via a single port connection managed through the Cloud Fabric Portal.

IP Bandwidth—Scalable from 10 Mbps up to 40 Gbps across all Flexential locations—and up to 100 Gbps at select sites—our IP bandwidth service enables you to seamlessly manage peak traffic and workload demands.

Cross Connects—Flexential low-latency, reliable, point-to-point connections help you reach the carriers, clouds, and IT service providers your business requires.

Network Hub—Bring connectivity closer to end users with geographically distributed locations that satisfy latency requirements and provide better application performance.

Connect anywhere

The centerpiece of Flexential Interconnection is our high-speed, private, secure network backbone. Our backbone is built to connect all of the data centers in our portfolio, as well as strategic carrier hotels. This means that once your data is on our network, it's on a private dedicated path to its destination. Your data does not ride over the internet. This provides security and increased performance because the packets aren't sharing space with unrelated traffic such as social media, streaming content, and malicious internet traffic. Flexential Interconnection is fast, simple, and secure.

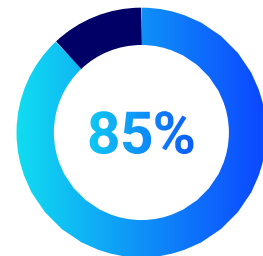

**By 2025,
85% of infrastructure strategies
will integrate on-premises, colocation,
cloud, and edge delivery options.**

—Gartner

Benefits

- ✓ Reduce latency and improve performance by distributing workloads and bringing applications closer to the user
- ✓ Modernize your network through technology enablement
- ✓ Scalable data center footprints and connectivity
- ✓ Private, secure, and reliable connectivity from the local edge to the cloud, and everything in between
- ✓ Optimize costs by placing data adjacent to the compute resources for faster more efficient workload processing
- ✓ Simple to build, scale, and deploy additional locations, capacity, and services, through an ecosystem of space, services, and interconnection designed to work together seamlessly

Flexential Interconnection access points

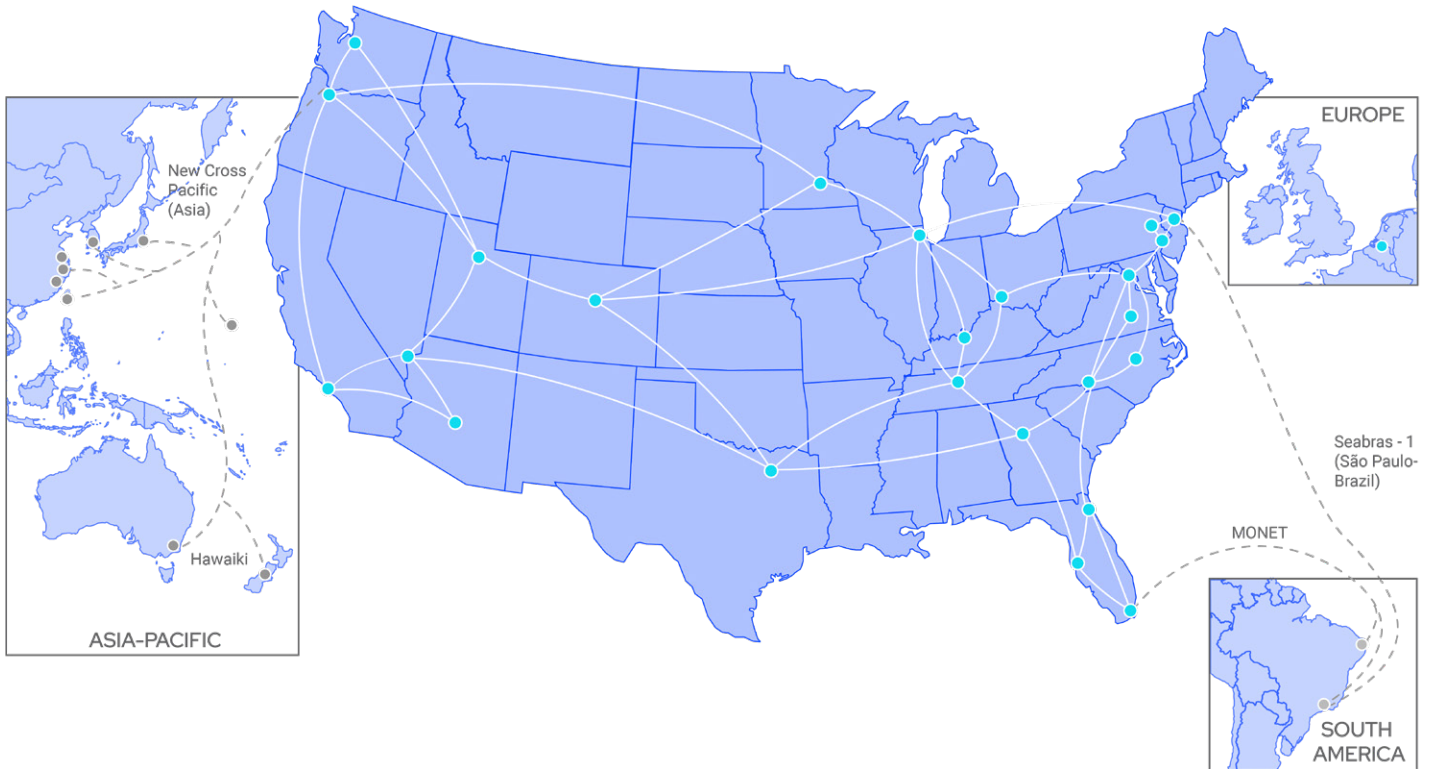

● Colocation | Network PoPs | Cloud on ramps | Cloud Fabric
— Network backbone - - - Subsea cables

Position workloads and data where they're needed

The growth of enterprise network-based applications, the Internet of Things, and Big Data are driving the next technological evolution. As the amount of data generated through these technologies increases exponentially, your connectivity and infrastructure needs will continue to change. Flexential Interconnection provides the flexibility to dynamically adjust your IT infrastructure by delivering the tools to move data and compute to the edge, easily integrate new technologies, and elastically adjust capacity.

Flexential is leading the way with rich, secure and broad connectivity to enable your success.

[Learn More](#) →



Downtown Denver data center

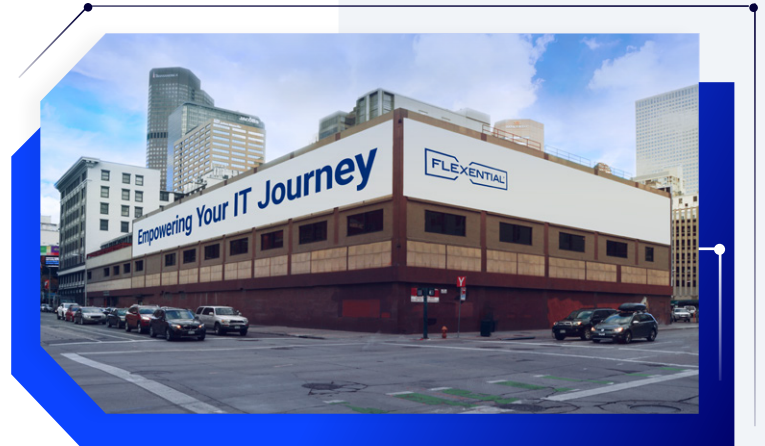

Our Downtown Denver data center is equipped to provide superior support for your IT transformation journey. It offers 2N UPS redundancy and a 100% service level agreement on power.

If you are in the healthcare industry or if you process credit card payments online, we are here to help secure, manage and maintain compliance. The Downtown Denver data center is certified for compliance with several industry and regulatory standards, including the HITRUST CSF and PCI DSS.

The best feature of our data center is the people who are on-site 24/7 to protect, monitor and support your infrastructure. Our local engineers and service staff are proven experts in managing and optimizing infrastructure, and we treat your environment as if it was our own. Our IT infrastructure solutions have one thing in common: a deeply ingrained “customer-first” culture. It means no matter what we’re providing - from colocation to cloud - we put the customer at the top of our org chart and empower all employees to provide the highest standards of service.

Quick facts

- 35,325-square-foot data center footprint
- 529 kW critical load UPS capacity; 2N UPS redundancy
- 100% SLA on power, network and bandwidth
- 4-zone security access

Additional features

- Migration and capacity planning
- Meeting room and dedicated work areas for customer use
- Office lease space available
- Remote hands support available
- Business continuity and disaster recovery services, solutions and support available
- Professional services including migration, security and risk management, assessments and audits, as well as performance and network architecture support, available

Facility specifications

Power & cooling

- 2N UPS redundancy
- 529 kW critical load UPS capacity
- Accommodate up to 5 KW per cabinet
- Hot/cold aisle configuration
- 100% power SLA
- 2.0 PUE rating

Compliance

- HITRUST CSF compliant site
- PCI DDS compliant site
- Annual, independent audits for SOC 1 Tier Type II, SOC 2 Type II, SOC 3; NIST 800-53; ITAR: SSAE 18
- HITRUST and PCI certification services available
- Regulatory and standards compliance assessment, analysis, consulting and planning services available

24/7 Security

- Round-the-clock security and technical staff
- Dual-factor authentication access
- PIN verification system
- 4-zone security access
- Monitored security cameras and intercom system
- Cage cameras available

Connectivity

- One unified fabric offering on-demand provisioning of connectivity services
- Connections to strategic carrier hotels
- 100Gbps network backbone
- Access to a rich ecosystem of carriers, service providers and cloud providers reachable from any data center
- IP transit service built on a blend of premium Tier I carriers and including basic DDoS scrubbing protection
- Point to point and mesh services available to connect Flexential data centers

Flexential solutions portfolio



Colocation



Interconnection



Cloud



Data Protection



Professional Services

[Request a tour](#) →



Aurora data center

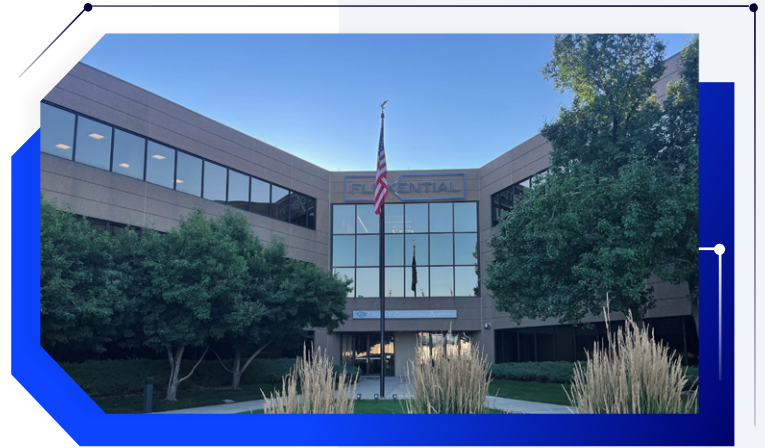

With a data center footprint exceeding 171,000 square feet, the Denver - Aurora data center offers ample colocation and connectivity services for any business. It is designed to power and cool even the most demanding environment, with fully redundant UPS power equipment and a redundant, energy-efficient cooling system.

This site is connected to our Denver cloud node as well as our network backbone with an industry-leading bandwidth of 100 gigabits per second, scalable to 400 Gbps. We are exceptionally equipped to support your IT transformation journey and deliver low latency and high capacity for your mission-critical applications. Rely on us for Layer 2 access to 80 on-net carriers, proactive Layer 3 and Layer 4 distributed denial of service protection and a 100% network and bandwidth uptime commitment.

If you are in the healthcare industry or if you process credit card payments online, we are here to help secure, manage and maintain compliance. The Denver - Aurora data center is certified for compliance with several industry and regulatory standards, including the HITRUST CSF and PCI DSS.

Quick facts

- 171,289-square-foot data center footprint
- 6.75 MW critical load UPS capacity; N+1 UPS redundancy
- N+1 cooling redundancy
- 100% SLA on power, network and bandwidth
- 100 Gbps network backbone, scalable to 400 Gbps
- 4-zone security access

Additional features

- Cloud node on-site
- Migration and capacity planning
- Meeting room and dedicated work areas for customer use
- Remote hands support available
- Business continuity and disaster recovery services, solutions and support available
- Public, private, hybrid and compliant cloud solutions, as well as cloud recovery and dedicated servers, available
- Professional services including migration, security and risk management, assessments and audits, as well as performance and network architecture support, available

Facility specifications

Power & cooling

- N+1 UPS redundancy
- 6.75 MW critical load UPS capacity
- 150 W/SF power density
- N+1 cooling redundancy
- Hot/cold aisle configuration
- 100% power SLA
- 1.4 PUE rating

Compliance

- HITRUST CSF compliant site
- PCI DSS compliant site
- Annual, independent audits for SOC 1 Tier Type II, SOC 2 Type II, SOC 3; NIST 800-53; ITAR: SSAE 18
- HITRUST and PCI certification services available
- Regulatory and standards compliance assessment, analysis, consulting and planning services available

24/7 Security

- Round-the-clock security and technical staff
- Dual-factor authentication access
- Biometric scanners
- 4-zone security access
- Monitored security cameras and intercom system
- Cage security cameras available

Connectivity

- One unified fabric offering on-demand provisioning of connectivity services
- Connections to strategic carrier hotels
- 100Gbps network backbone
- Access to a rich ecosystem of carriers, service providers and cloud providers reachable from any data center
- IP transit service built on a blend of premium Tier I carriers and including basic DDoS scrubbing protection
- Point to point and mesh services available to connect Flexential data centers

Flexential solutions portfolio



Colocation



Interconnection



Cloud



Data Protection



Professional Services

Request a tour 



Centennial data center



Our Denver - Centennial data center is equipped to provide superior support for your IT transformation journey. With a data center footprint exceeding 43,000 square feet, this site offers ample colocation and connectivity services for any business.

The Denver - Centennial data center is connected to our network backbone with an industry-leading bandwidth of 100 gigabits per second, scalable to 400 Gbps. We are exceptionally equipped to deliver low latency and high capacity for your mission-critical applications. Rely on us for Layer 2 access to 80 on-net carriers, proactive Layer 3 and Layer 4 distributed denial of service protection and a 100% network and bandwidth uptime commitment.

This site is certified for compliance with several industry and regulatory standards, including the HITRUST CSF and PCI DSS. We are among a select few in the industry that can provide a certified, protected environment to support compliance with these standards.

Quick facts

- 43,294-square-foot data center footprint
- 1.60 MW critical load UPS capacity; 2N UPS redundancy
- N+1 cooling redundancy
- 100% SLA on power, network and bandwidth
- 100 Gbps network backbone, scalable to 400 Gbps
- 4-zone security access

Additional features

- Migration and capacity planning
- Meeting room and dedicated work areas for customer use
- Office lease space available
- Remote hands support available
- Business continuity and disaster recovery services, solutions and support available
- Public, private, hybrid and compliant cloud solutions, as well as cloud recovery and dedicated servers, available
- Professional services including migration, security and risk management, assessments and audits, as well as performance and network architecture support, available

Facility specifications

Power & cooling

- 2N UPS redundancy
- 1.60 MW critical load UPS capacity
- 150 W/SF power density
- N+1 cooling redundancy
- Hot/cold aisle configuration
- 100% power SLA
- 1.8 PUE rating

Compliance

- HITRUST CSF compliant site
- PCI DDS compliant site
- Annual, independent audits for SOC 1 Tier Type II, SOC 2 Type II, SOC 3; NIST 800-53; ITAR: SSAE 18
- HITRUST and PCI certification services available
- Regulatory and standards compliance assessment, analysis, consulting and planning services available

24/7 Security

- Round-the-clock security and technical staff
- Dual-factor authentication access
- Biometric scanners
- 4-zone security access
- Monitored security cameras and intercom system
- Cage cameras available

Connectivity

- One unified fabric offering on-demand provisioning of connectivity services
- Connections to strategic carrier hotels
- 100Gbps network backbone
- Access to a rich ecosystem of carriers, service providers and cloud providers reachable from any data center
- IP transit service built on a blend of premium Tier I carriers and including basic DDoS scrubbing protection
- Point to point and mesh services available to connect Flexential data centers

Flexential solutions portfolio



Colocation



Interconnection



Cloud



Data Protection



Professional Services

[Request a tour](#) →



Englewood data center

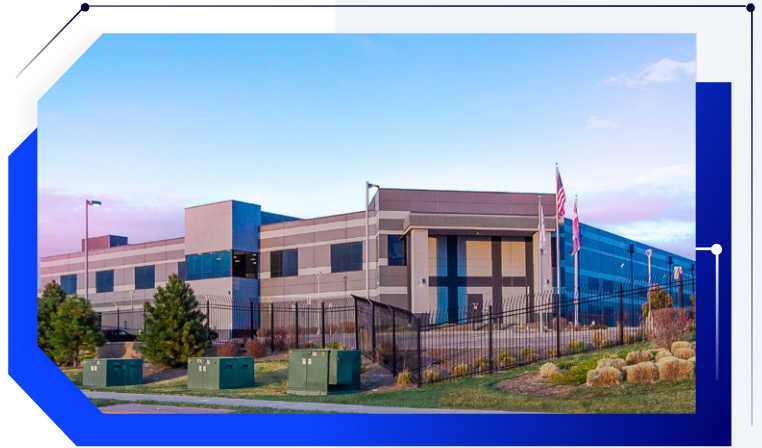

With a data center footprint approaching 250,000 square feet, the Denver - Englewood data center, located in the Denver metropolitan area, is one of the largest single-floor data halls in the world. It has module-redundant UPS power equipment and multiple redundant fiber-optic telecommunication networks. This means your mission-critical data is always available. As a Generation 4 data center, this facility is purpose-built to accommodate power densities of over 1,500 watts per square foot, with 24-foot ceilings, proprietary and highly efficient cooling units and a pressurized raised floor.

With a cloud node on-site and a network backbone of 100 gigabits per second, scalable to 400 Gbps, we are exceptionally equipped to support your IT transformation journey and deliver low latency and high capacity for your mission-critical applications.

Rely on us for Layer 2 access to 80 on-net carriers, proactive Layer 3 and Layer 4 distributed denial of service protection and a 100% network and bandwidth uptime commitment.

If you are in the healthcare industry or if you process credit card payments online, we are here to help secure, manage and maintain compliance. The Denver - Englewood data center is certified for compliance with several industry and regulatory standards, including the HITRUST CSF and PCI DSS.

Quick facts

- 240,549-square-foot data center footprint
- 18 MW critical load UPS capacity; Distributed Redundant 4:3 UPS
- N+2 cooling redundancy
- 100% SLA on power, network and bandwidth
- 4-zone security access

Additional features

- Cloud node on-site
- Migration and capacity planning
- Meeting room and dedicated work areas for customer use
- Office lease space available
- Remote hands support available
- Business continuity and disaster recovery services, solutions and support available
- Public, private, hybrid and compliant cloud solutions, as well as cloud recovery and dedicated servers, available
- Professional services including migration, security and risk management, assessments and audits, as well as performance and network architecture support, available

Facility specifications

Power & cooling

- Distributed Redundant 4:3 UPS
- 18 MW critical load UPS capacity
- 1500 W/SF power density
- N + 2 cooling redundancy
- Hot/cold aisle configuration
- 100% power SLA
- 1.3 PUE rating

Compliance

- HITRUST CSF compliant site
- PCI DDS compliant site
- Annual, independent audits for SOC 1 Tier Type II, SOC 2 Type II, SOC 3; NIST 800-53; ITAR: SSAE 18
- HITRUST and PCI certification services available
- Regulatory and standards compliance assessment, analysis, consulting and planning services available

24/7 Security

- Physical environment, power delivery, generator and diesel fuel infrastructure monitoring
- Round-the-clock security and technical staff
- Dual-factor authentication access
- Biometric scanners
- 4-zone security access
- Monitored security cameras and intercom system
- Cage cameras available

Connectivity

- One unified fabric offering on-demand provisioning of connectivity services
- Connections to strategic carrier hotels
- 100Gbps network backbone
- Access to a rich ecosystem of carriers, service providers and cloud providers reachable from any data center
- IP transit service built on a blend of premium Tier I carriers and including basic DDoS scrubbing protection
- Point to point and mesh services available to connect Flexential data centers

Flexential solutions portfolio



Colocation



Interconnection



Cloud



Data Protection



Professional Services

[Request a tour](#) →



Englewood 2 data center



Englewood 2 data center is located just one mile from the Flexential Englewood facility. The newest build includes 22.5 MW and 249,000 sq. ft. and sits on 17 acres powered by Core Electric. This purpose-built data center will provide high density colocation and be liquid cooled-ready.

Englewood 2 will be at the corner of Chambers Road and Compark Blvd. about 1 mile east of Flexential Englewood, located at 8636 S. Peoria St., Englewood, CO.

Flexential Englewood 2 puts your data closer to users in the Midwest, improves application response times and create predictable performance for distributed users in regional markets.

- Provide a secure and reliable network to core data centers and deliver network hubs in a standard, repeatable fashion.
- Improve network reliability to your cloud service providers to give end users better performance and reduce single points of failure on the network.

Denver is technology and innovation driven by advancements in data-centric sectors from finance and mobility to logistics, retail, and healthcare IT. This market convergence creates limitless growth potential.

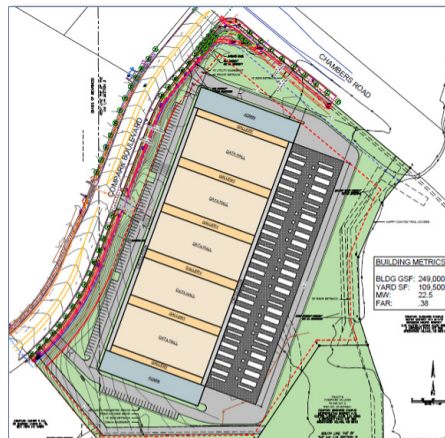

Quick facts

- 249,000-square-foot data center footprint
- 22.5 MW critical load UPS capacity; Distributed Redundant 4:3 UPS
- N+2 cooling redundancy
- 100% SLA on power, network and bandwidth
- 5-zone security access

Additional features

- Migration and capacity planning
- Meeting room and dedicated work areas for customer use
- Office lease space available
- Remote hands support available
- Business continuity and disaster recovery services, solutions and support available
- Public, private, hybrid and compliant cloud solutions, plus cloud recovery and dedicated servers, available
- Professional services including migration, security and risk management, assessments, and audits, as and performance and network architecture support, available

Facility specifications

Power & cooling

- 22.5 MW of critical power
- 4.5 MW per Data Hall
- Distributed redundant topology (4:3)
- 415V and 208V delivery
- 5-minute battery reserve
- 50 MW of standby power generation
- Primary utility power provided by Graystone
- 25 MW of total cooling
- Ultra-efficient cooling design to optimize PUE
- Day one support for all forms of liquid cooling
- Day one support for high-density environments

Compliance

- PCI DSS compliant site
- Annual, independent audits for SOC 1 Tier Type II, SOC 2 Type II, SOC 3; NIST 800-53; ITAR: SSAE 18
- HITRUST and PCI certification services available
- Regulatory and standards compliance assessment, analysis, consulting and planning services available

24/7 Security

- Round-the-clock security and technical staff
- Dual-factor authentication access
- Biometric scanners
- 5-zone security access
- Monitored security cameras and intercom system
- Cage security cameras available

Connectivity

- One unified fabric offering on-demand provisioning of connectivity services
- Connections to strategic carrier hotels
- 100Gbps network backbone
- Access to a rich ecosystem of carriers, service providers and cloud providers reachable from any data center
- IP transit service built on a blend of premium Tier I carriers and including basic DDoS scrubbing protection
- Point to point and mesh services available to connect Flexential data centers

Flexential solutions portfolio



Colocation



Interconnection



Cloud



Data Protection



Professional Services